

14836ST – ACCESSIBLE SHOWERS

inches

Interior: 48 x 36 x 77

Exterior: 50 5/8 x 38 1/2 x 79

The 14836ST accessible shower features innovative installation design, including an engineered leveled base. A true time and money saver, our pre-leveled base lets you install directly on a **level** floor. And its front threshold is engineered to keep a constant level without the use of brackets during installation.



FEATURES

- Pre-leveled base
- AcrylX™ applied acrylic surface
- 4" skirt
- Large subway tile pattern
- Center drain
- Lifetime limited warranty (30 year commercial)

OPTIONS

- RH or LH fixture wall
- Grab bars
- Fold-up seat
- Hand-held shower assembly with slide bar
- Pressure balancing mixing valve
- Soap dish
- Curtain rod and/ or shower curtain

CODE COMPLIANCE

- IAPMO Z124-2017
- CSA B45-11
- ICC/ANSI A117.1

AQUATIC ADVANTAGE

- 7 manufacturing facilities
- Private fleet
- Centralized customer service
- Field support

COLOR & TRIM OPTIONS

Stock	Upgraded
White	Almond Biscuit Bone

**Additional custom colors available.
(Contact Customer Service)



Aquatic products may be
specified as Lasco Bathware.



Aquatic products may be specified as Lasco Bathware.

14836ST

Interior: 48 x 36 x 77
Exterior: 50 5/8 x 38 1/2 x 79
inches

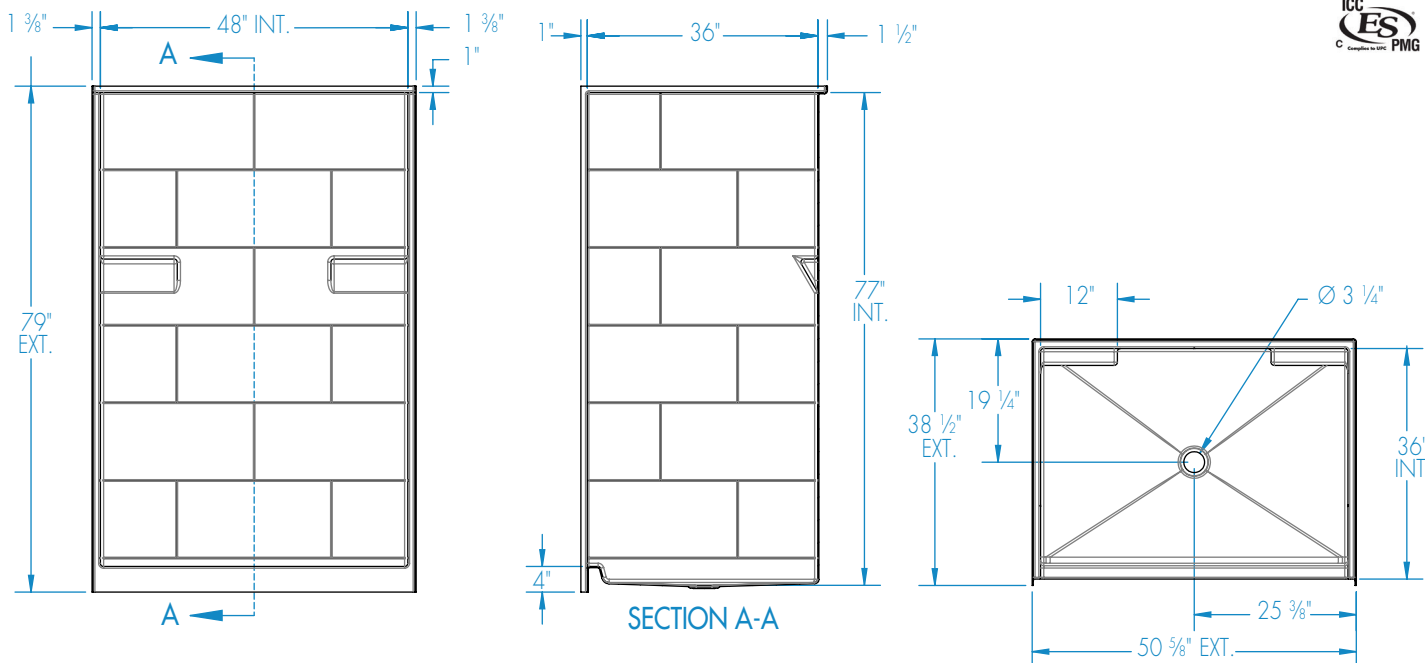

FEATURES

Dimensional Tolerance $\pm 3/8$ ". Dimensions needed for site preparation should be measured from the unit. Aquatic assumes no responsibility for preparatory work.

Type and Model #	Material	Wall Finish	Pieces	Drain	Dam/Skirt Height	Net Wt. lbs	Pkg. Wt. lbs
Shower #14836ST	AcrylX™	Smooth tile	1	Center	4" skirt	110	120

DIMENSIONS

Specifications	inches
Width: Overall / Net	50 5/8 / 48
Depth: Overall / Net	38 1/2 / 36
Height: Overall / Net	79 / 77
Enclosure Opening:	48
Skirt Height:	4
Drain Rough-In (from Back Wall)	19 1/4
Drain Rough-In (from Side Wall)	25 1/2

FRAMING DIMENSIONS inches

Type	D Depth	W Width	H Height	A	B	C
Alcove	38 1/2	50 7/8	-	Box Out	25 1/2	19 1/4

