

# 14836BFSBTTR – ACCESSIBLE SHOWERS

Interior: 48 x 36 x 76 ¾

Exterior: 54 x 38 ½ x 78 ¾

inches

The 14836BFSBTTR accessible shower features innovative installation design, including an engineered leveled base and improved front threshold with molded integral linear trench drain. A true time and money saver, our pre-leveled base lets you install directly on a **level** floor. And its front threshold is engineered to keep a constant level with the innovative nailing line flange.



Shown fully-equipped

## AQUATIC ADVANTAGE

- National distribution
- 7 manufacturing facilities
- Private fleet
- Centralized customer service
- Field support

## COLOR & TRIM OPTIONS

Stock	Upgraded
White	Biscuit Bone

\*\*Additional custom colors available.  
(Contact Customer Service)

## FEATURES

- Pre-leveled base
- AcrylX™ applied acrylic surface
- ½" skirt
- ½" beveled threshold
- Barrier free when properly installed
- Smooth large subway tile wall
- Center front drain outlet
- Integral front trench drain
- Lifetime limited warranty

## OPTIONS

- Grab bars
- Fold-up seat
- Hand-held shower assembly with slide bar
- Pressure balancing mixing valve
- Large soap dish
- Small soap dish
- Curtain rod and/or shower curtain

## CODE COMPLIANCE

- FHA
- ICC/ANSI A117.1
- HUD UM73a
- CSA B45.5-11/  
IAPMO Z124-2017

\*\*Code compliant when fully equipped and installed according to guidelines.



Aquatic products may be specified as Lasco Bathware.



Interior: 48 x 36 x 76 ¾  
Exterior: 54 x 38 ⅞ x 78 ¾  
inches

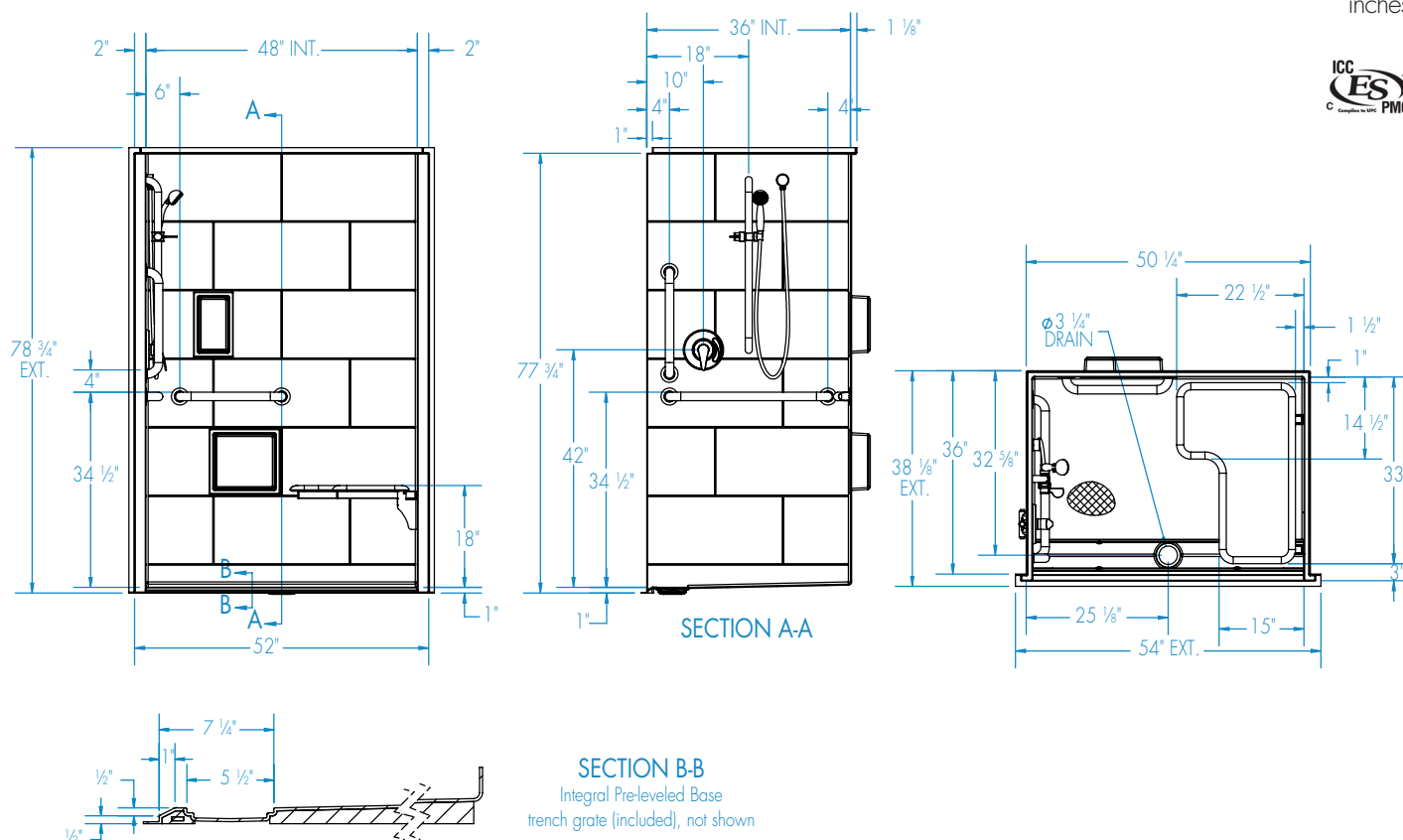

**FEATURES**

Dimensional Tolerance ± 3/8". Dimensions needed for site preparation should be measured from the unit. Manufacturer assumes no responsibility for preparatory work.

Type and Model #	Material	Wall Finish	Pieces	Drain	Dam/Skirt Height	Net Wt. lbs	Pkg. Wt. lbs
Shower 14836BFSBTTR	Acrylix™	Smooth tile	1	Center Front	½" skirt ½" beveled threshold	160	170

**DIMENSIONS**

Specifications	inches
Width: Ext. / Int.	54 / 48
Depth: Ext. / Int.	38 ⅞ / 36
Height: Ext. / Int.	78 ¾ / 76 ¾
Enclosure Opening:	48
Skirt Height:	½
Drain Rough-In (from Back Wall)	32 ⅝
Drain Rough-In (from Side Wall)	25 ⅞

**FRAMING DIMENSIONS** inches

Type	D Depth	W Width	H Height	A	B	C
Alcove	36	50 ¼	-	Box Out	25 ⅞	32 ⅝

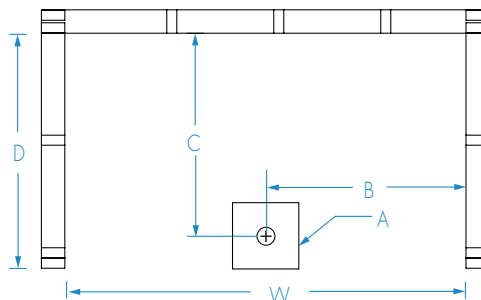

**Aquatic products may be specified as Lasco Bathware.**